

Delaney Shay Sound Design

Sound Engineer: TBD

Rev	By	Notes
3/09	DRS	Added Spkr
4/02	ARNL	Fixed spacing

General Notes:

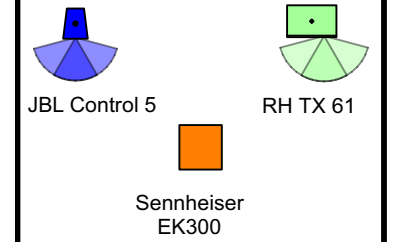

Purdue Theatre

In The Blood

By: Suzan-Lori Parks

Director	
Scenic Designer	
Lighting Designer	
Costume Designer	
Drawn By	JRS

DISCLAIMER: The designer is responsible for the aural aspects of the production only, and all specifications provided relate solely to the appearance of the sound system and not to matters of electrical or structural soundness and/or safety. The implementation of this design must comply with the most stringent applicable federal and local safety and fire certificates. The designer is not qualified to determine the electrical or structural appropriateness of the design and will not assume responsibility for damages resulting through improper engineering and/or implementation in the handling of the elements of the sound design. The designer agrees to make prompt alterations to any specification found to be incompatible with proper safety precautions.

Plan - Deck Level

SPV

Scale	
Revision	Zack Bennett - 09/11/18
Plate #	01 of 6

ORIGINALLY PRINTED AT 17" x 11"

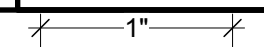

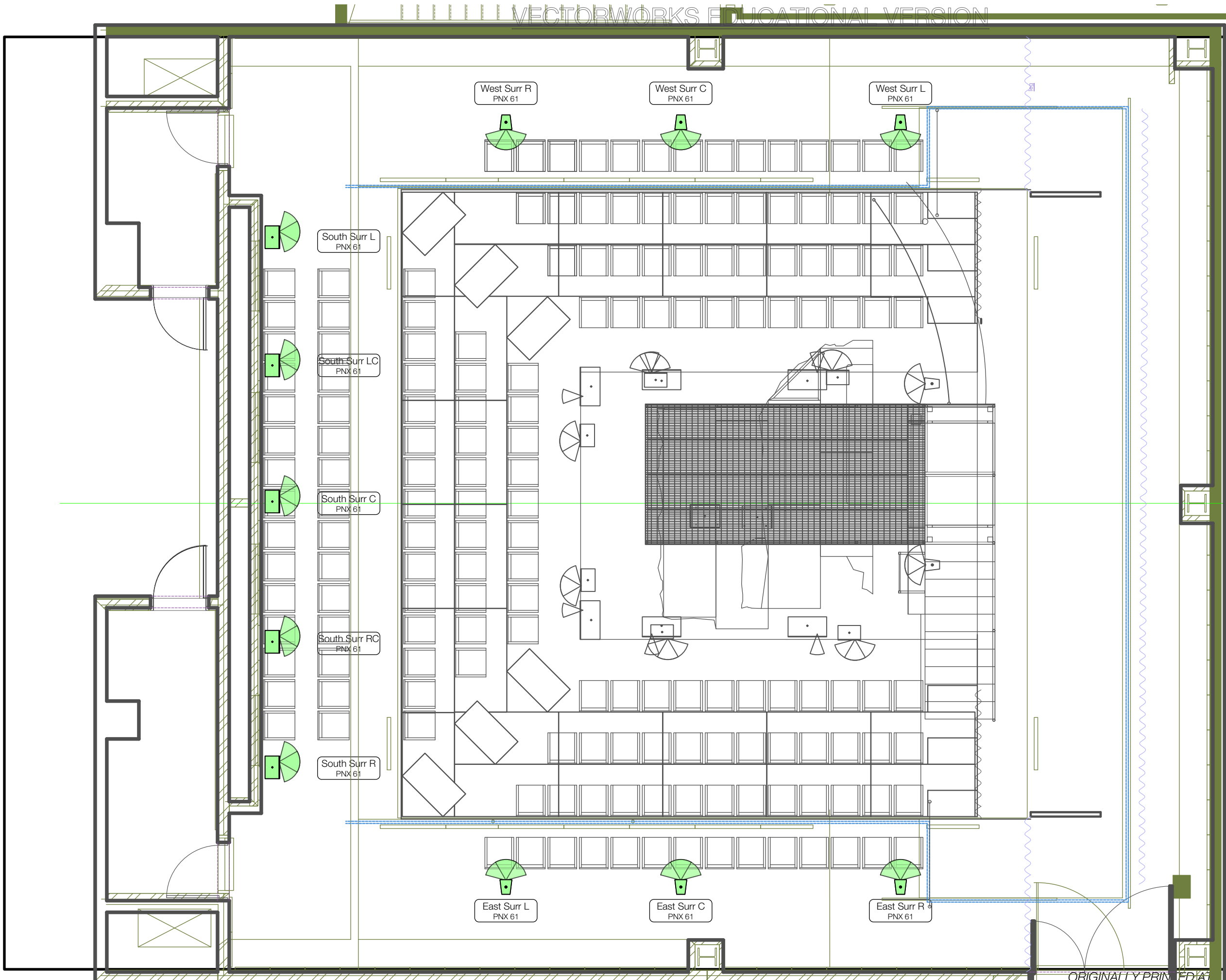

Delaney Shay Sound Design

Sound Engineer: TBD

Rev	By	Notes
3/09	DRS	Added Spkrs
4/02	ARNL	Fixed spacing

General Notes:

Purdue Theatre

In The Blood

By: Suzan-Lori Parks

Director
Scenic Designer
Lighting Designer
Costume Designer
Drawn By JRS

DISCLAIMER: The designer is responsible for the aural aspects of the production only, and all specifications provided relate solely to the appearance of the sound system and not to matters of electrical or structural soundness and/or safety. The implementation of this design must comply with the most stringent applicable federal and local safety and fire codes. The designer is not qualified to determine the electrical or structural appropriateness of the design and will not assume responsibility for damages resulting through improper engineering and/or implementation in the handling of the elements of the sound design. The designer agrees to make prompt alterations to any specification found to be incompatible with proper safety precautions.

Plan - Flying

SPV

Scale
Revision Zack Bennett - 09/11/18
Plate # 02 of 6

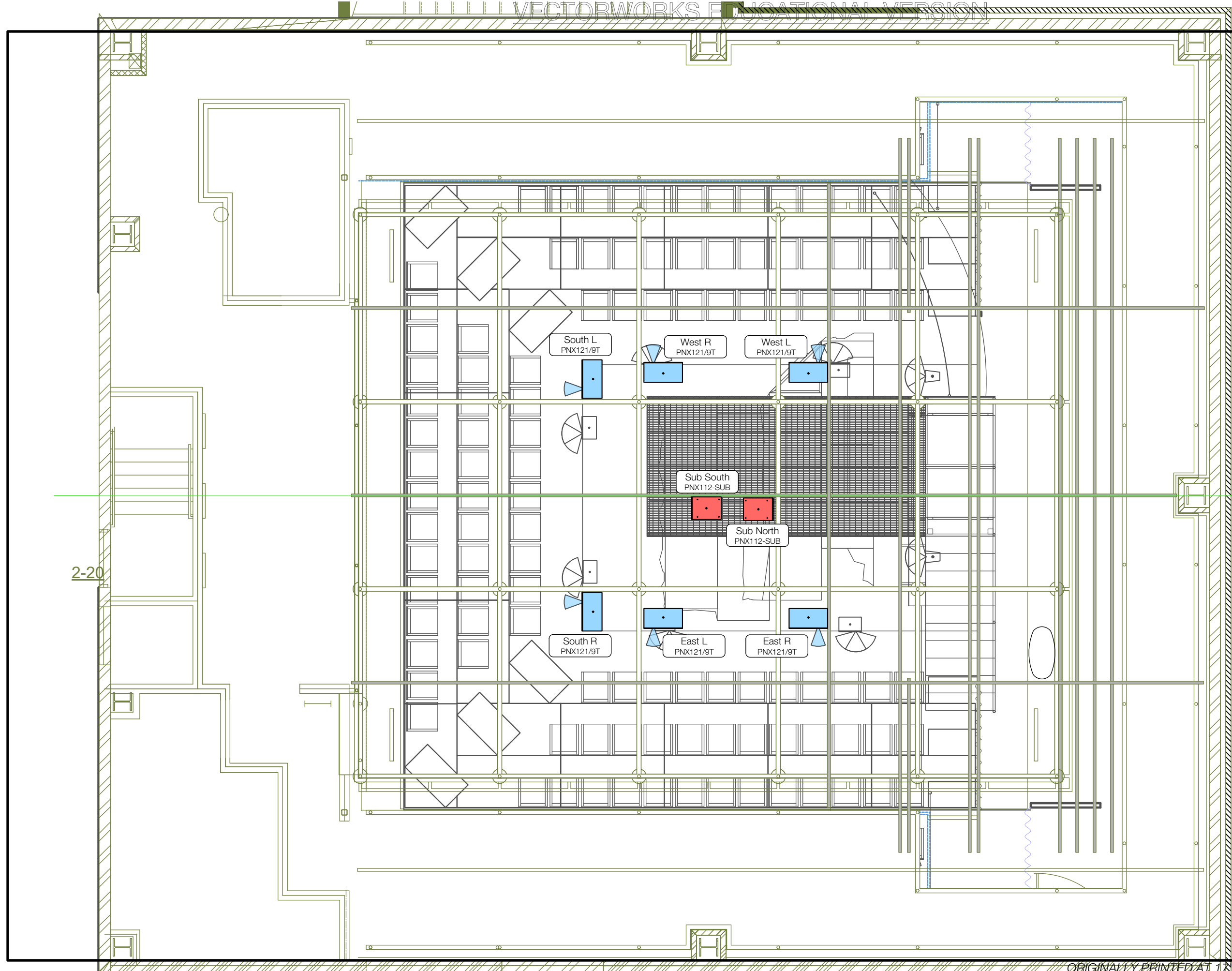

Delaney Shay Sound Design

Sound Engineer: TBD

Rev	By	Notes
3/09	DRS	Added Spkrs
4/02	ARNL	Fixed spacing

General Notes:

Purdue Theatre

In The Blood

By: Suzan-Lori Parks

- Director
- Scenic Designer
- Lighting Designer
- Costume Designer
- Drawn By JRS

DISCLAIMER: The designer is responsible for the aural aspects of the production only, and all specifications provided relate solely to the appearance of the sound system and not to matters of electrical or structural soundness and/or safety. The implementation of this design must comply with the most stringent applicable federal and local safety and fire certificates. The designer is not qualified to determine the electrical or structural appropriateness of the design and will not assume responsibility for damages resulting through improper engineering and/or implementation in the handling of the elements of the sound design. The designer agrees to make prompt alterations to any specification found to be incompatible with proper safety precautions.

Plan - Grid Level

SPV

Scale

Revision Zack Bennett - 09/11/18

Plate # **03** of 6

ORIGINALLY PRINTED AT 1/8" x 11"

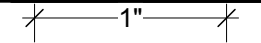

**Delaney Shay
Sound Design**

Sound Engineer: TBD

Rev	By	Notes
3/09	DRS	Added Spkrs
4/02	ARNL	Fixed spacing

General Notes:

Purdue Theatre

**In
The
Blood**
By: Suzan-Lori Parks

Director
Scenic Designer
Lighting Designer
Costume Designer
Drawn By JRS

DISCLAIMER: The designer is responsible for the aural aspects of the production only, and all specifications provided relate solely to the appearance of the sound system and not to matters of electrical or structural soundness and/or safety. The implementation of this design must comply with the most stringent applicable federal and local safety and fire certificates. The designer is not qualified to determine the electrical or structural appropriateness of the design and will not assume responsibility for damages resulting through improper engineering and/or implementation in the handling of the elements of the sound design. The designer agrees to make prompt alterations to any specification found to be incompatible with proper safety precautions.

Section - HL

SPV

Scale
Revision Zack Bennett - 09/11/18
Plate # **04** of 6

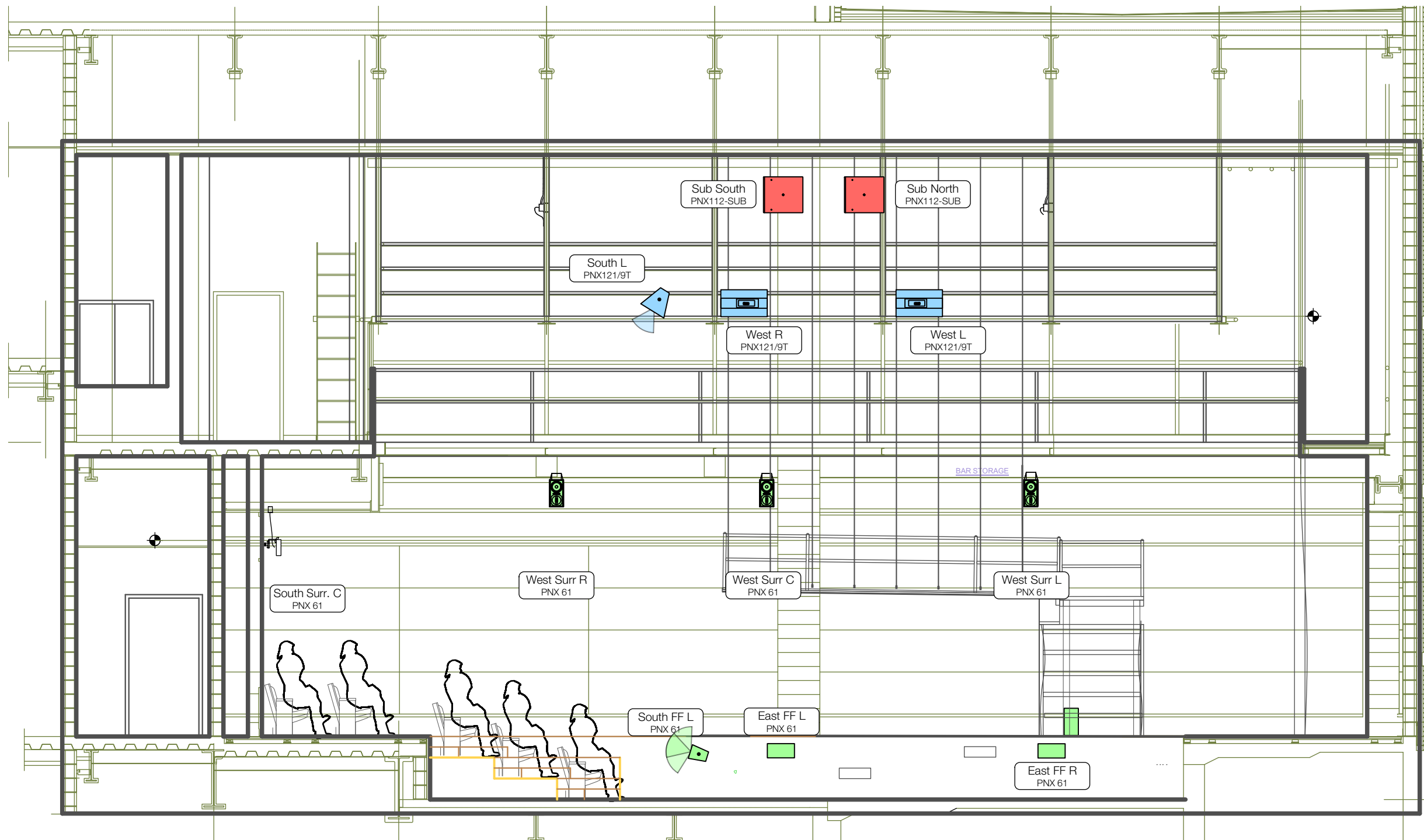

ORIGINALLY PRINTED AT 17" x 11"

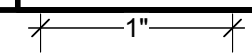

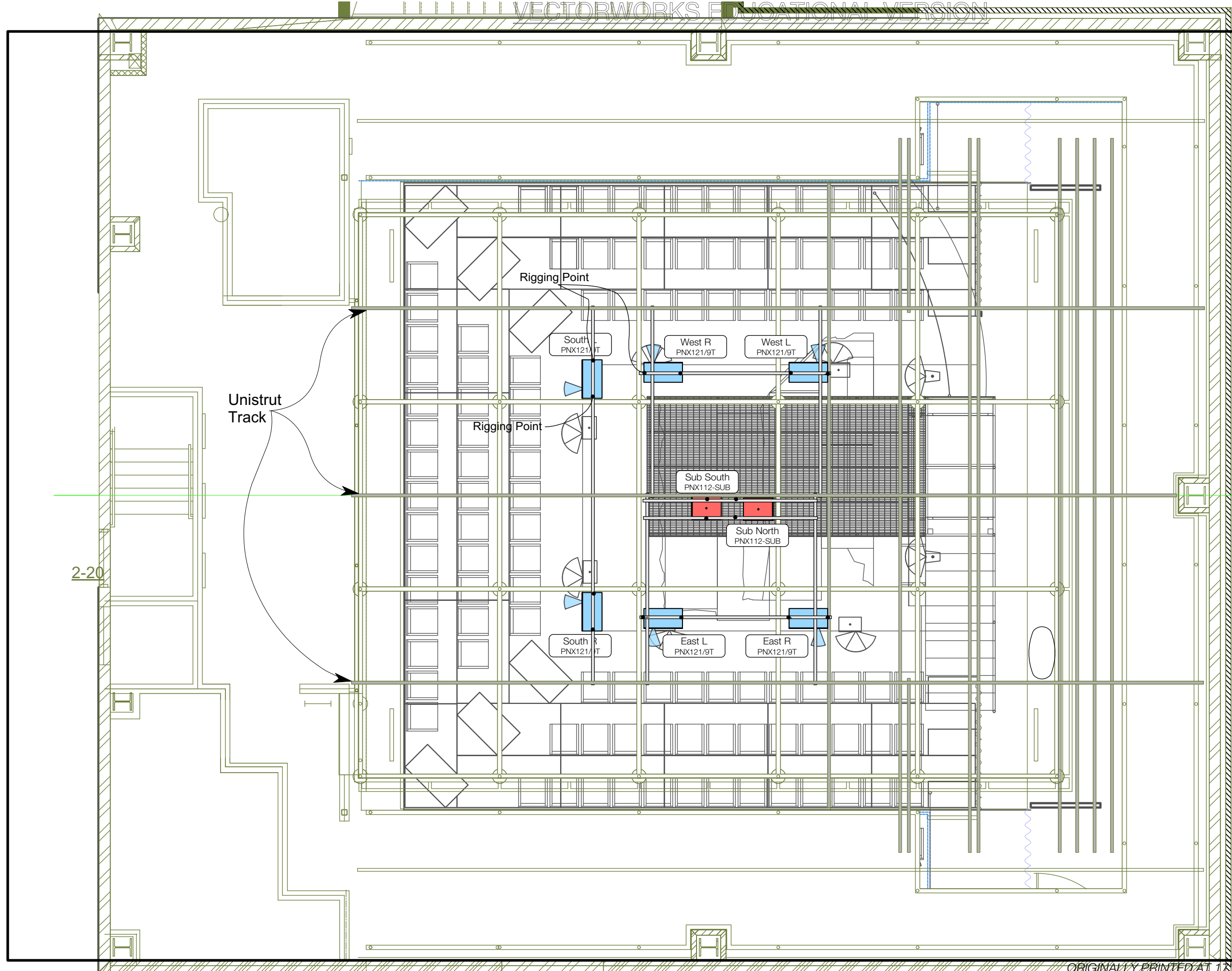

Delaney Shay Sound Design

Sound Engineer: TBD

Rev	By	Notes
3/09	DRS	Added Spkrs
4/02	ARNL	Fixed spacing

General Notes:

Purdue Theatre

In The Blood

By: Suzan-Lori Parks

Director
Scenic Designer
Lighting Designer
Costume Designer
Drawn By JRS

DISCLAIMER: The designer is responsible for the aural aspects of the production only, and all specifications provided relate solely to the appearance of the sound system and not to matters of electrical or structural soundness and/or safety. The implementation of this design must comply with the most stringent applicable federal and local safety and fire certificates. The designer is not qualified to determine the electrical or structural appropriateness of the design and will not assume responsibility for damages resulting through improper engineering and/or implementation in the handling of the elements of the sound design. The designer agrees to make prompt alterations to any specification found to be incompatible with proper safety precautions.

Grid Level Rigging
SPV

Scale
Revision Zack Bennett - 09/11/18
Plate # **05** of 6

ORIGINALLY PRINTED AT 1/8" x 11"

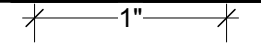

**Delaney Shay
Sound Design**

Sound Engineer: TBD

Rev	By	Notes
3/09	DRS	Added Spkrs
4/02	ARNL	Fixed spacing

General Notes:

Purdue Theatre

**In
The
Blood**

By: Suzan-Lori Parks

Director

Scenic Designer

Lighting Designer

Costume Designer

Drawn By JRS

DISCLAIMER: The designer is responsible for the aural aspects of the production only, and all specifications provided relate solely to the appearance of the sound system and not to matters of electrical or structural soundness and/or safety. The implementation of this design must comply with the most stringent applicable federal and local safety and fire codes. The designer is not qualified to determine the electrical or structural appropriateness of the design and will not assume responsibility for damages resulting through improper engineering and/or implementation in the handling of the elements of the sound design. The designer agrees to make prompt alterations to any specification found to be incompatible with proper safety precautions.

Section - Rigging

SPV

Scale

Revision Zack Bennett - 09/11/18

Plate # **06** of 6

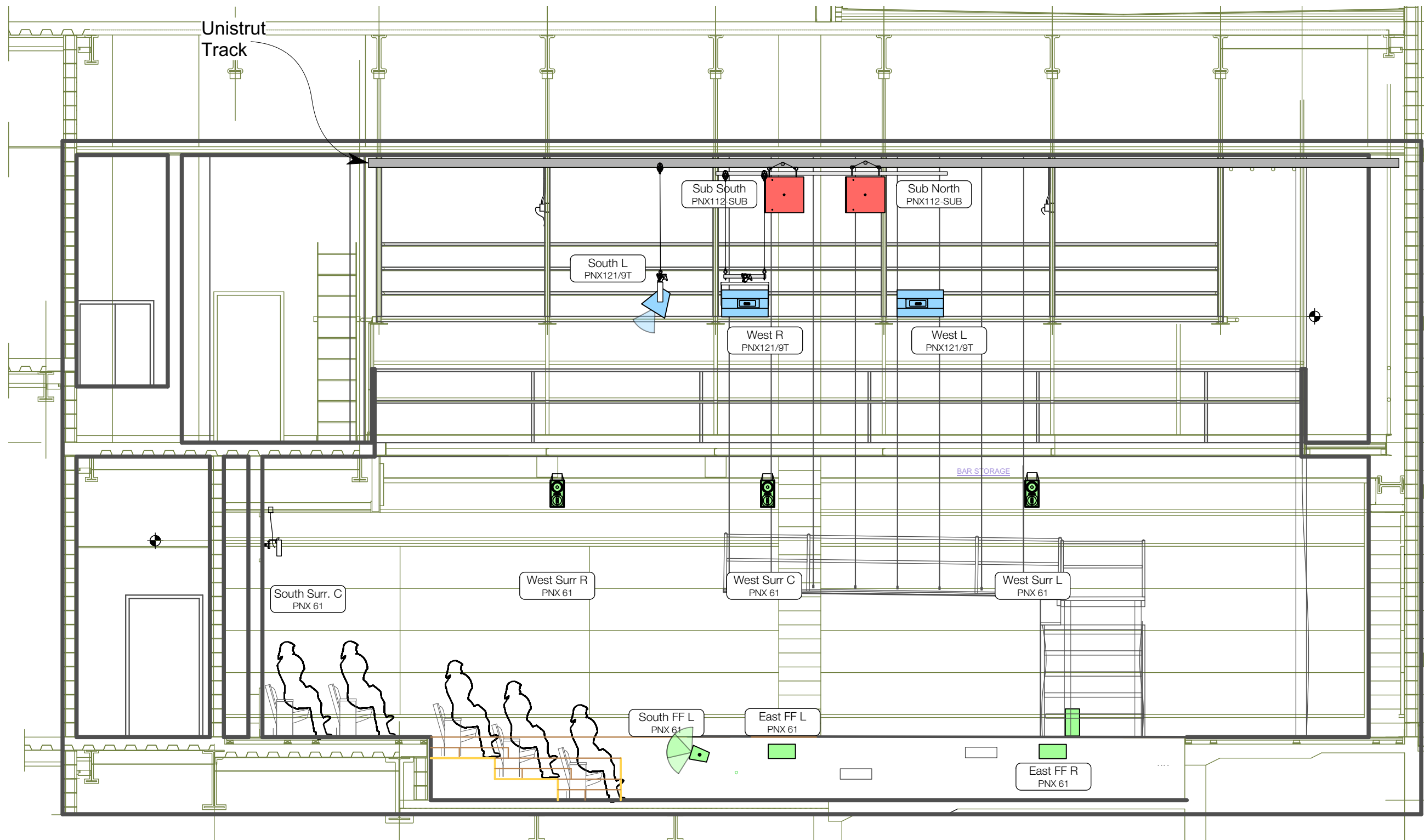

ORIGINALLY PRINTED AT 17" x 11"

